

## Type J15, 'P' Series Pilot Valve

**CALL:** +44 (0)1254 872277  
**E-MAIL:** sales@pneumatrol.com

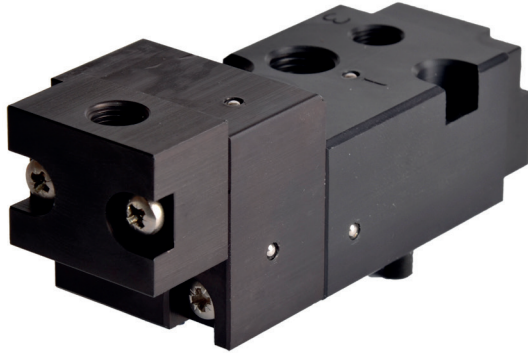

### DESCRIPTION

Pilot valve designed for direct mounting onto 1/4 turn pneumatically operated valve actuators meeting 'NAMUR' standard fixing dimensions.

Body material available in

- Aluminium (standard)
- Stainless Steel
- Brass

Seal kit available – VSKC15P

### FEATURES

- Top face air connection
- 1/4" BSP mains air connection and 1/8" BSP exhaust ports, also available in NPT ports
- Integrated Exhaust to Spring (ETS) feature in 3/2 position
- Single pilot spring return function or double pilot stay put function
- Built in 3/2 to 5/2 function conversion facility for spring return and double acting actuators respectively

**PRODUCT CODE: J 1 5**  **P 0 0 0 0 0** 





OPERATOR

OPTIONS







SEE BELOW FOR  
PRODUCT CODE  
DETAILS

Any of the below options that are not required enter '0' in relevant box.

#### Operator

-   Spring return, external pilot air connection
-   Double solenoid, external pilot air connection

#### Options

-  Valve body brass
-  Valve body brass and NPT ports
-  NPT ports
-  Valve body stainless steel and NPT ports
-  Valve body stainless steel
-  Valve suitable for use with Oxygen

**CONVERSION FACILITY**

The valve is fitted with a change-over plate that allows the valve to be converted from 3/2 to 5/2 function quickly and easily.

In 3/2 function a proportion of clean air exhausting from the actuator is fed back into the spring chamber.

**DIMENSIONS (mm)**

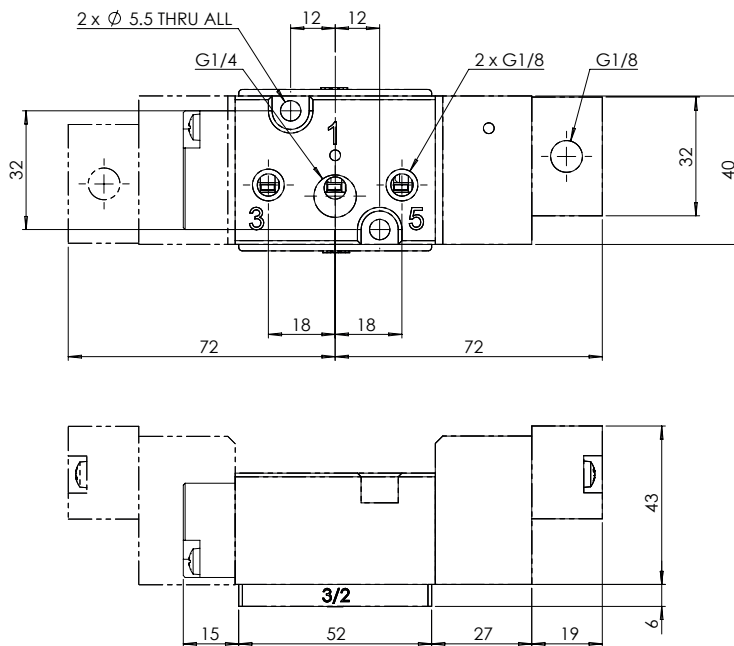

**MATERIAL SPECIFICATIONS**

	STANDARD
Body and End Caps	Black Anodised Aluminium (Dural)
Spool	Hard Anodised Aluminium PTFE Impregnated
Spacers	Glass Filled Acetal
Seals	Nitrile
Spring	Music Wire
Mounting Screws	Stainless Steel
Change Over Plate	Nylon 66 30% Glass Filled
Gasket	Nitrile

**VALVE SPECIFICATIONS**

	STANDARD
Port Connection Size	1/4" BSP
Pilot Port Connection Size	1/8" BSP
Working Pressure	3 to 10 bar
Pilot Signal Pressure	3 to 10 bar
Cv Factor	0.7
Flow Rate (at 6 bar with 1 bar pressure drop)	675 l/min
Maximum Ambient Temperature	+80 °C
Minimum Working Temperature	-20 °C