

E23A-G Series, Gang Mounted, Direct Acting, 1/4", 3/2 Function Solenoid Valve

CALL: +44 (0)1254 872277
E-MAIL: sales@pneumatrol.com



DESCRIPTION

Gang Mounted, 3 port 2 position direct acting available in normally closed or normally open configuration solenoid valves, for the operation of single acting pneumatic devices.

Body material available in

- Aluminium (standard)
- Stainless Steel
- Brass

FEATURES

- Single air inlet connection port

PRODUCT CODE: **E 2 3 A** G C 0 N

OPERATOR
COIL
OPTIONS 1
BANK No.
VOLTAGE
OPTIONS 2

SEE BELOW FOR PRODUCT CODE DETAILS
 Any of the below options that are not required enter '0' in relevant box.

Operator

- X Spring return, normally closed
- Y Spring return, normally open

Coil

- P Plug & Socket

Options 1

- C Lever manual override

Bank No.

- 2 Bank of two (2)
- 3 Bank of three (3)
- 4 Bank of four (4)
- 5 Bank of five (5)
- 6 Bank of six (6)
- 7 Bank of seven (7)
- 8 Bank of eight (8)
- 9 Bank of nine (9)
- A Bank of ten (10)

Standard Voltage

- B 24v DC
- H 24v DC Low Power
- R 24v AC (50/60 Hz)
- T 110v AC (50/60 Hz)
- N 220v AC (50/60 Hz)
- U 240v AC (50/60 Hz)

*** A comprehensive range of non-standard voltages available on request**

Options 2

- N NPT ports

DIMENSIONS (mm)

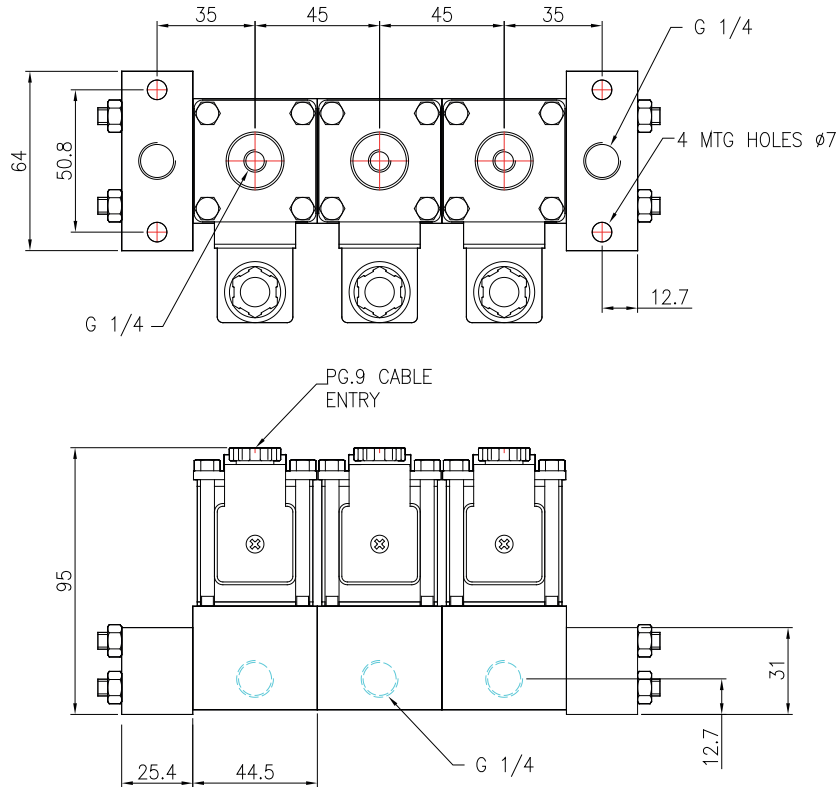

MATERIAL SPECIFICATIONS

	STANDARD
Body	Black Anodised Aluminium (Dural)
Jet	Brass
Tie Rods & Nuts	Stainless Steel
End Blocks	Black Anodised Aluminium (Dural)

VALVE SPECIFICATIONS

	STANDARD
Port Connection Size	1/4" BSP
Working Pressure	0 to 10 bar
Cv Factor	0.18
Flow Rate (at 6 bar with 1 bar pressure drop)	187 l/min
Maximum Ambient Temperature	+80 °C
Minimum Working Temperature	-20 °C
Inlet Orifice Size	2.0 mm
Exhaust Orifice Size	2.5 mm

COIL DETAILS

Coil Type	Plug & Socket
Area Class	Safe
Area Category	N/A
Ingress Protection	IP65
Cable Entry	PG.9
Ambient Temperature	-20 to +80 °C
Magnetic Wire Class	H